



CONFERENCES & EVENTS



## MEETING RATES

In today's world time is a precious commodity, whether in business or leisure. At Sandford Springs we understand the importance of not just time but quality time. Whether you are looking to host an intimate business meeting for a few colleagues, or source an outstanding venue to entertain corporate guests for away days, team buildings or events, you will find what you need at Sandford Springs resort. With modern facilities, friendly service and an exceptional location, you will find everything in place to ensure the success of your corporate entertaining requirements.

### Day delegate starting from £36 excluding VAT

Including:

- Meeting room hire fully set to your specifications
- Unlimited servings of tea, coffee & biscuits
- Seasonal fresh fruit platter
- Sandwich or finger buffet lunch
- Screen and flipchart
- Unlimited and complimentary WiFi access for all delegates
- Bottled mineral water
- Delegate stationery for use throughout the day
- Complimentary parking

### 24-Hour delegate rack rate starting from £140 excluding VAT

Including:

- All day delegate package items
- Three-course dinner (private room available on request)
- Full English breakfast
- Accommodation
- Free car parking for duration of stay
- Complimentary WiFi access

For further details on all our delegate rates please contact our events team on **01635 296811** or email us at **[info@sandfordsprings.co.uk](mailto:info@sandfordsprings.co.uk)**



**50 minutes to Heathrow**



**15 minutes to Newbury Train Station  
13 minutes to Basingstoke Train Station**



**20 minutes to M4 junction 13  
13 minutes to M3 junction 6**

## CAPACITIES

Whatever you are looking for, from residential conferences right through to intimate meetings for business colleagues, here at Sandford Springs we have the ideal venue for you.

The following details the rooms which we have available for meetings and events, and the capacities of each. Feel free to contact us to discuss your requirements further, and gain assistance in selecting the ideal location to meet your needs.

### Meeting Room Dimensions

Room	Size (m)	Floor Area (m <sup>2</sup> )
The Garden Suite	14.6 x 15.5	
The Sandford Lounge	13.7 x 10	
The Boardroom	5.5 x 4.25	23.37
The Clock House Suite	15 x 4.5	67.5
Leaderboard Suite	6.4 x 4.5	28.8
Davies Suite	7.3 x 4.5	32.85

### Meeting Room Capacities

Room	Boardroom	U-Shape	Cabaret	Theatre	Dinner
The Garden Suite	30	32	84	120	140
The Sandford Lounge	10	25	30	60	60
The Boardroom	10	-	-	-	12
The Clock House Suite	30	-	-	50	-
Leaderboard Suite	18	16	-	26	-
Davies Suite	15	18	-	20	-

### Combined Meeting Room Dimensions

Room	Size (m)	Floor Area (m <sup>2</sup> )
Leaderboard Suite & Davies Suite	14 x 4.5	
The Garden Suite & Sandford Lounge		

### Combined Meeting Room Capacities

Room	Boardroom	U-Shape	Cabaret	Theatre	Dinner
Leaderboard Suite & Davies Suite	38	34	-	-	-
The Garden Suite & Sandford Lounge	-	-	-	-	180

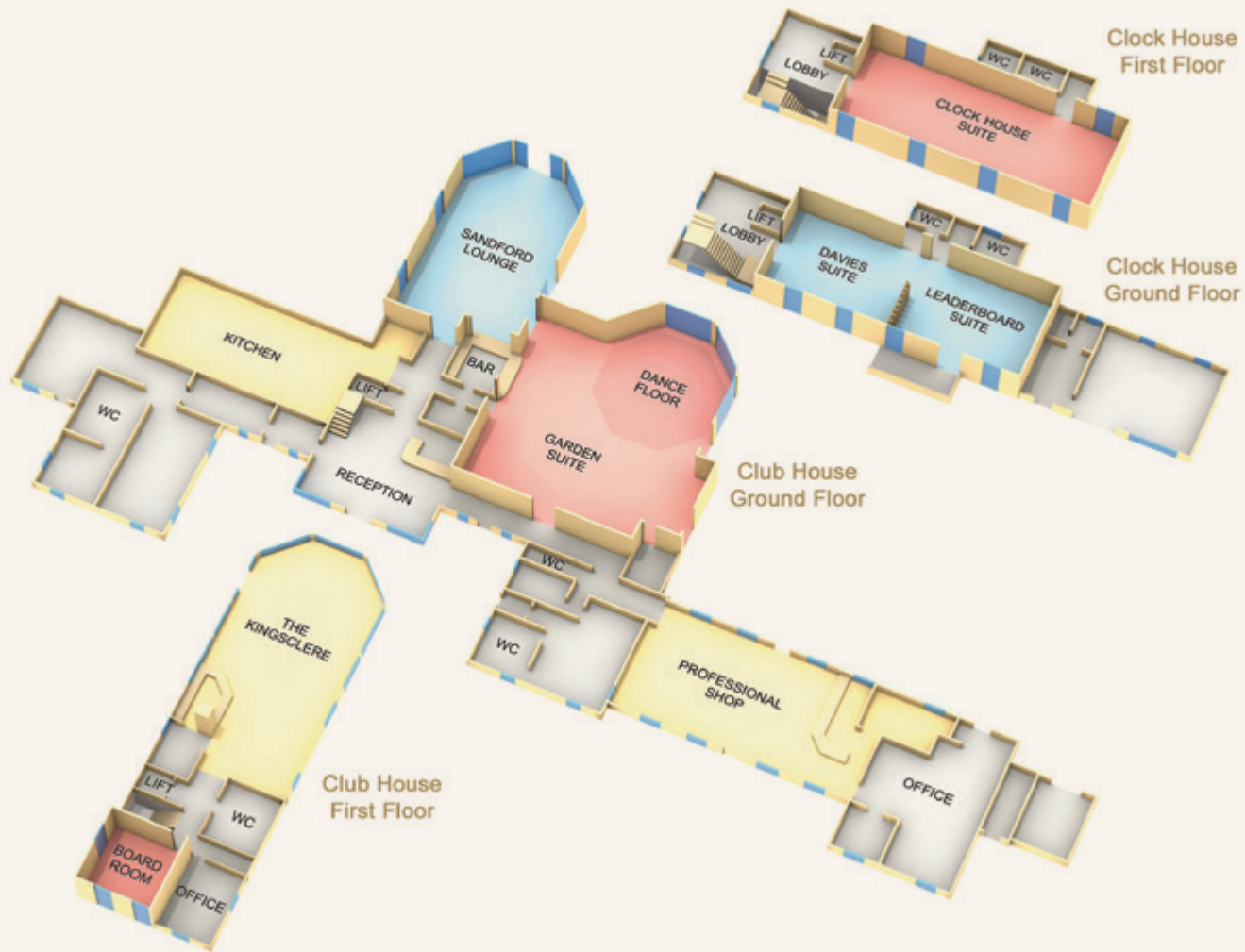





## TEAM BUILDING FACILITIES AT SANDFORD SPRINGS

All businesses need time to spend on team building and staff morale. Taking your team away from the daily grind to an outstanding location without ringing telephones, email requests and an ever-expanding to do list can work wonders when it comes to strengthening your staff's teamwork abilities and developing them professionally.

We work with various specialist companies to help deliver the right product for you, with an extensive range of options for strategic indoor team building days. Beginner group golf lessons are also available on site for groups of up to 8 people with our PGA professional teachers.

With complimentary Wi-Fi, superbly appointed conference facilities and an extensive bespoke dining service, you will be able to design the ideal event for your staff. We also provide the environment to combine business with pleasure, taking time out for a relaxing game of golf after a successful morning's business, or treating yourself to a meal in our Kingsclere Bar and Restaurant.

For further details on all our team building options please contact our events team on **01635 296811** or email us at **[info@sandfordsprings.co.uk](mailto:info@sandfordsprings.co.uk)**



**Sandford Springs Golf Club**  
Kingsclere, Hampshire RG26 5RT

t. 01635 296800 e. [golf@sandfordsprings.co.uk](mailto:golf@sandfordsprings.co.uk)  
w. [sandfordsprings.co.uk](http://sandfordsprings.co.uk)

 **Leaderboard**  
...owners of fine golf courses